

TPS 34 Passenger Stairs



Base, Line Maintenance &
Ground Handling Equipment



Ground Handling Equipment

Reliable easy to use low maintenance equipment
for efficient ramp operations.



Key features

- Low cost fixed height stair specifically designed for A320 series aircraft.
- Stable yet highly maneuverable and easy to set up.
- Easily towable with Ackerman steering for maximum stability.
- Low maintenance.
- Low through life cost.



TPS 34 Passenger Stairs

The TPS 34 passenger stair is designed specifically for the A320 family of aircraft with a fixed stairway and top-platform mounted on a welded steel chassis frame. The step treads and top-platform walking area are surfaced with grip faced aluminium tread plate to provide a smart, stylish appearance and passenger security in all weathers.

Light weight yet robust construction saves time and effort when manually maneuvering the steps, to and from the aircraft.

Sliding top platform panels with hand operated spring locking bolts are fitted to both sides of the top platform facilitate opening the aircraft doors with the steps fully interfaced to the aircraft.

A rubber buffered pivoting section is fitted at the leading edge of the top-platform to interface with fuselage contours. The standard unit has tubular/sheet steel side-panels with extrusion trimmed handrails fitted to both sides of the stair flight. The sliding top platform panels are fully sheeted with D-Rubber buffers to the leading edge

The TPS 34 offers a stylish, low cost option for single aircraft fleet A320 operations.

As standard the chassis-frame and tow-bar are galvanised to ISO1461. All other sections are painted in a single corporate colour top-coat. High visibility markings are applied to front/rear chassis corners and sides of tow-bar.

TPS 34

Passenger Stairs

Product code:

With Canopy 4000-190-00-00

Without Canopy 4000-191-00-00

Options & extras

- Pneumatic tyres (puncture prevention by foam filling if required).
- Alternative type stabiliser jacks.
- Special corporate markings / livery.
- Mesh sheet panels on the stair-flight side-rails.
- Battery powered stairway illumination.
- Canopy (as illustrated).

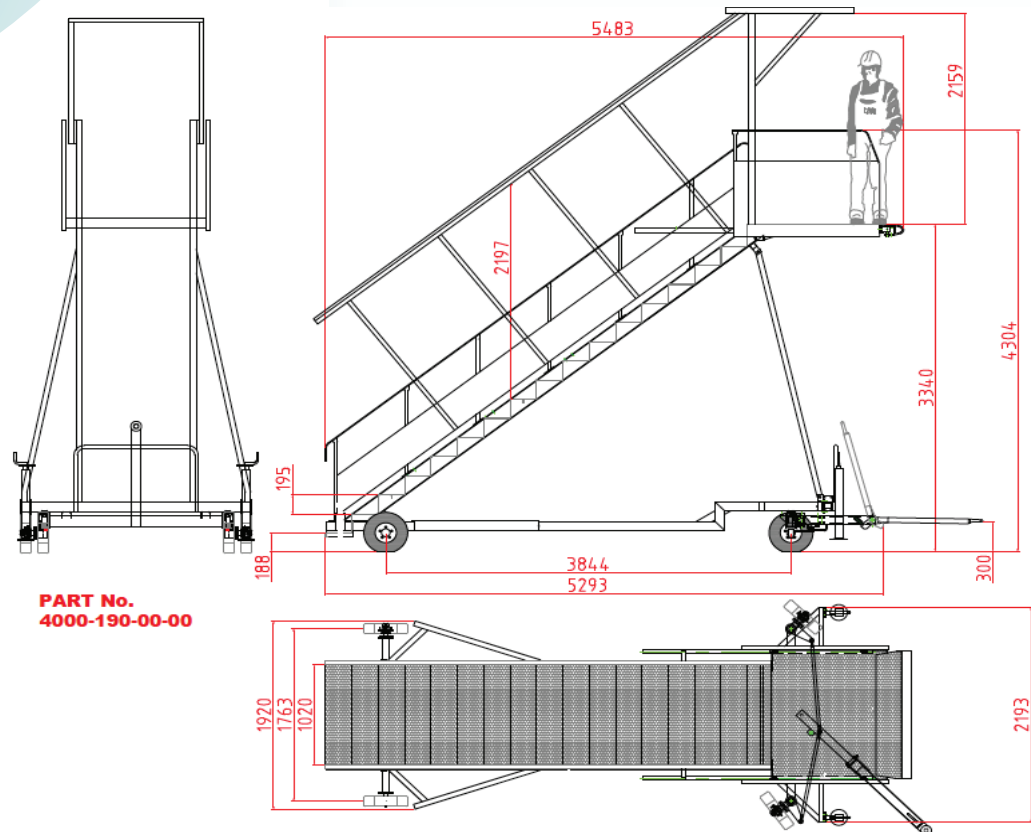

Illustration shows stairs with Optional Metal Canopy.

Specifications

Top platform Height	3,340mm
Stair Riser Height	196mm
Stair Tread Depth	250mm
Stair Tread Width	1,020mm
Top Platform Width	1,340mm
Top Platform Length	1,400mm
Overall Weight	1,200 kg

Please note that every effort is made to ensure that all dimensions are correct, however we do reserve the rights to make changes at our own discretion.



Waterton House,
Waterton Industrial Estate
Bridgend, South Wales, CF31 3US
United Kingdom



Tel +44 (0) 1656 652 202
Email info@tbduk.co.uk
www.tbduk.co.uk